

Quick Setup Balloon Light Tower 1000W For Construction Sites Roadworks Mining Sites

Our Product Introduction

for more products please visit us on ushineraylight.com

Basic Information

- Place of Origin: Shenzhen, Guangdong, China
- Brand Name: UShineray
- Certification: CE ROHS ETL
- Model Number: YXR-BL-1000W



Product Specification

- Beam Angle(°): 360 Degrees
- Lumen: 160000lm
- Dimmable: 4-Level Dimming
- Product Name: 1000W LED Balloon Light Tower
- Application: Construction Sites Roadworks Mining Sites
- Power: 1400W
- Tripod Max Height: 3.8m, 4.2m, 4.6m Or Customized
- Material: Aluminum + S.steel + PC + Fabric
- Control: Switch On-off, Knob Switch For Dimming, Remote Control
- Balloon Diffuser: Yellow/Blue/Black Top-Reflective Diffuser Or All White
- Balloon Size: D1100*H860 Or Customized
- Input Voltage: 90~305Vac
- Waterproof: IP65



More Images



Product Description

Quick Setup Balloon Light Tower 1000W For Construction Sites Roadworks Mining Sites

Quick Setup 1000W Balloon Light Tower, ideal for construction sites, roadworks, and mining operations. Provides high-intensity lighting for nighttime work, ensuring safety and efficiency. Durable, portable, and easy to assemble, perfect for demanding industrial environments and projects.

Product Features

Effective Filter: Prevents mosquitoes, dust, and debris from entering, ensuring optimal performance and longevity.

360-Degree Illumination: Provides comprehensive wide-area lighting.

Soft, Non-Glare Light: Diffused and lightweight, enhancing portability.

Energy-Efficient: Delivers $\geq 160\text{lm/W}$ with low power consumption.

Adjustable Brightness: Features a dimmable adjustment knob on the lamp or remote control, and includes an on-off switch.

Easy Setup: Equipped with a foldable tripod and cover for quick and straightforward assembly.

Robust Balloon Design: Waterproof, UV resistant, and fire retardant, with a lifespan exceeding 50,000 hours.

Product Parameter

Item No.	YXR-BL-1000W-A
Power	1000W
Input Voltage	AC90-305V
Lumen(lm)	160000
Weight(kg)	25.7
Inflated Dimension	D1100*H860
Efficacy	$160\pm 5\%$ lm/W
CCT	5000K or 3000K
CRI	$\geq 70\text{Ra}$
LED Chips	Lumileds 2835
LED Driver	Inventronics
PF	≥ 0.95
Dimming Control Mode	Knob switch or Remote control
Remote Control Distance	60m
Life Span	≥ 50000 hrs
IP Grade	IP65
Cable Length(m)	10
Tripod Height(min-max)	1.62~3.8m
Tripod Collapsed Height	1.8m
Tripod Footprints	1.4m
Tripod Weight	11.5kg

Product Details

1000W Illumination



Lumen up to **160000lm**
Illumination range up to 6400 m²



Equipped with a brightness adjustment knob

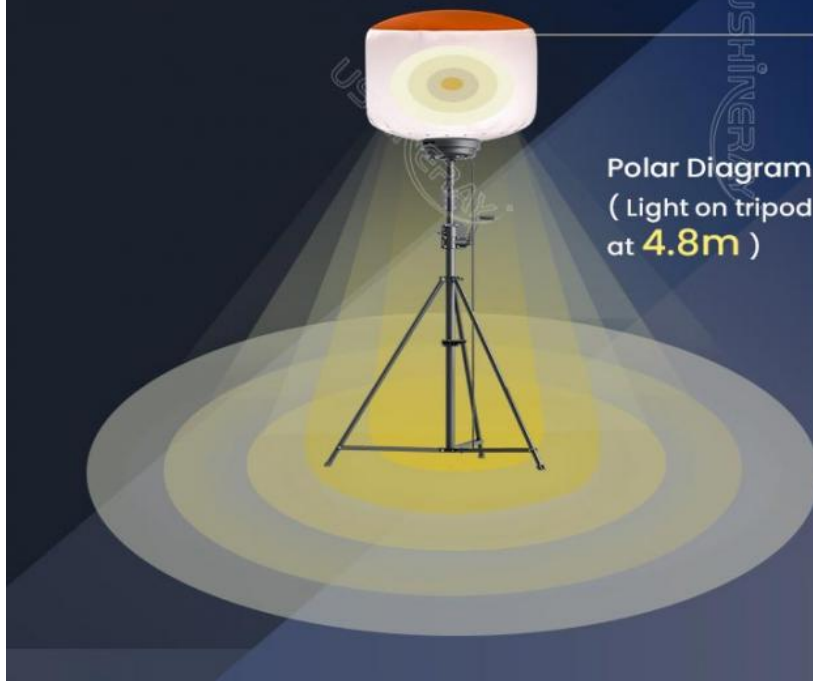

Polar Diagram
(Light on tripod
at **4.8m**)

360 degrees glare-free illumination. High lumen up to 160000lm, illumination range up to 6400 m². Equipped with a brightness adjustment knob.

PRODUCT FEATURES



The product features of the bottom of the lamp body include cotter safety pin, On/Off switch, filtration device, safety pin, bracket interface, power line.

AND PATENTED DESIGN



Aluminum construction with powder coated panels on all components



Modular panels with waterproof lenses



Built-in stainless steel protective cover



Superior IP65 water & dust protection, UV resistance, flame retardant for commercial industrial environments



Velcro straps for removing balloon diffusers cleaning and replacement

The patented design ensures excellent heat dissipation for the lamp body, enhancing its performance and longevity. It features a built-in stainless steel protective cover, providing superior protection for the internal PC lens and LED chips. This robust construction not only safeguards sensitive components but also increases the durability and reliability of the light, making it ideal for tough working environments.



Effectively filter out dust and insects

Unique design: Air filtration function
Effectively filter out dust and insects, protect the lamp body, making better lighting performance.

Package included

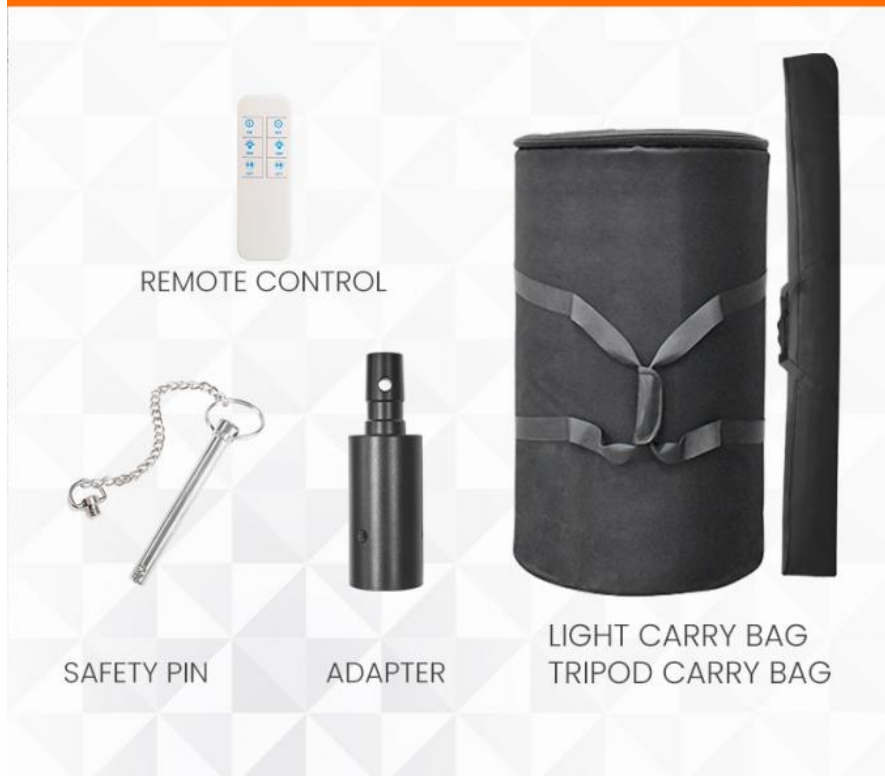

Package included: Safety pin, adapter, portable light carry bag, and tripod carry bag.
Also comes with secure fasteners, high-quality straps, and reinforced handles for easy transport and added convenience during setup.



Features of the balloon diffuser include IP65 waterproof rating, ensuring protection against water and dust. It is also dustproof, anti-UV for sun resistance, and flame retardant, providing enhanced safety and durability in harsh environments.

The 1000W Balloon Light Tower is designed for a wide range of applications, including construction sites, roadworks, and mining sites. Its powerful illumination ensures safety and visibility during nighttime or low-light operations. Ideal for large-scale outdoor projects, it provides uniform, glare-free lighting, making it perfect for working areas where precision and safety are critical. The durable and portable design allows for easy transport and quick setup, making it a versatile lighting solution for industrial, infrastructure, and emergency situations.

USHINERAY Shenzhen Yongxinrui Lighting Technology Co., Ltd.

+8613410523891

joy@ushineray.com

ushineraylight.com

4F, Building C, Junxing Optoelectronic Industrial Park, Fuyuan 2nd Road, FuHai Street, Bao'an District, Shenzhen